

SJM Disc Coupling

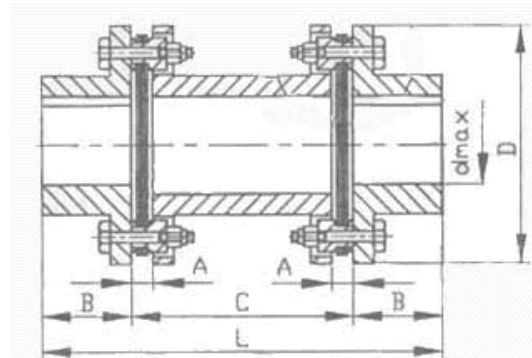

Part NO.	Nominal Torque N.M	Rev Limit rpm	Weight kg	kg.cm2	Dimensions mm						Compensation		
					d _{max}	D	A	B	L	C	Axial mm	Angular	Radial mm
SJM 00	9.8	20000	0.23	3.0	20	57	4.9	20	100	60	±1.6	2°	0.5
SJM 01	33	20000	1.2	8	22	68	6.1	26	141	89	±1.6	2°	0.5
SJM 02	90	20000	1.9	24	32	81	6.6	26	141	89	±1.6	2°	0.5
SJM 03	173	18000	2.9	48	35	93	8.4	29	160	102	±2.4	2°	0.6
SJM 04	245	15000	4.7	80	42	104	11.2	34	195	127	±2.8	2°	0.7
SJM 05	420	13000	7.1	224	50	126	11.7	42	211	127	±3.2	1°30'	0.7
SJM 06	772	12000	10.8	440	60	143	11.7	48	223	127	±3.6	1°30'	0.8
SJM 07	1270	10000	16.3	1080	75	168	16.8	58	243	127	±4.0	1°30'	0.8
SJM 08	2080	10000	24.7	2080	82	194	17.0	64	268	140	±4.4	1°30'	0.9
SJM 09	3328	9000	32.5	3520	95	214	21.6	77	306	152	±4.8	1°30'	0.9
SJM 10	4900	8000	50.0	7200	108	246	23.9	89	356	178	±5.2	1°30'	1.0
SJM 11	6368	8000	75.0	12800	118	276	27.2	102	382	178	±5.6	1°30'	1.2
SJM 12	8900	6300	72.2	18000	110	276	17.5	128	409	153	±3.6	1°	1.2
SJM 13	15280	5000	12.0	37000	135	308	19.0	160	492	172	±4.0	1°	1.2
SJM 14	25410	4700	175	68000	155	346	21.5	182	554	190	±4.0	1°	1.2
SJM 15	37130	4300	234	108000	165	375	24.0	198	620	224	±4.0	1°	1.3
SJM 16	47120	3900	306	167000	180	410	29.5	214	682	254	±4.4	1°	1.3
SJM 17	57000	3500	369	250000	190	445	29.5	225	720	270	±4.4	1°	1.4
SJM 18	63186	3500	448	311000	205	470	31.0	248	770	274	±4.8	1°	1.5
SJM 19	82590	3200	596	480000	230	512	32.0	278	843	287	±4.8	1°	1.6
SJM 20	102100	2800	763	747000	255	556	32.5	305	902	292	±5.2	1°	1.8
SJM 21	126070	2450	919	1016000	265	588	34.0	318	948	312	±5.4	1°	1.8
SJM 22	146350	2150	1068	1386000	275	630	34.5	332	1008	344	±5.6	1°	2.0
SJM 23	173830	2000	1235	1784000	290	655	35.5	348	1052	356	±6.0	1°	2.0

Notes: 1, Hub Material C45 Steel; Disc Material: Stainless Steel

2, Surface treatment: Black Oxide

3, Bore can be pilot bore and finished bore with keyway.